

Installing guide for a RACHIELE Under Mount sink

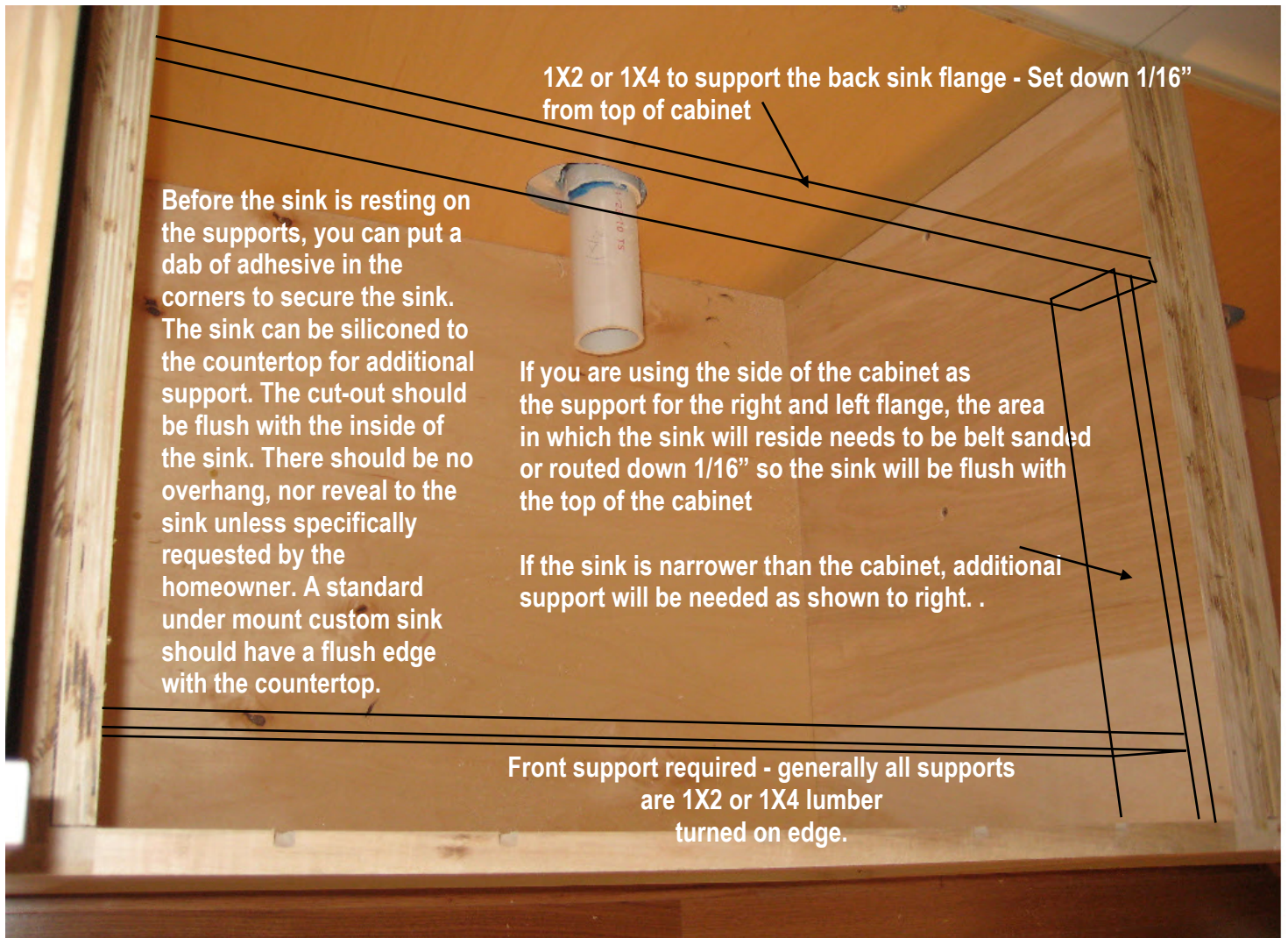

Installing a Rachiele under mount sink should be quite simple and fast. If you are installing a sink that is the same cabinet width as the cabinet, you will only need a front and rear support. You can use the side of the cabinet for support. You must rout out or belt sand down the area where the sink will rest by 1/16" - the thickness of our sink material. You would want our sink to be flush with the top of the cabinet.

If your cabinet has corner gussets or side supports, and they are in the way, they can be safely removed. I have checked with several major manufacturers. They all say they are not necessary once the cabinet is installed.

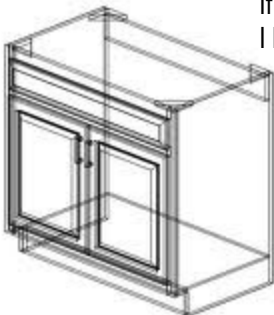

As always, I try to answer the phone evenings and weekends, so if you have questions, please call. Be sure to leave a message in the event I do not answer. I try to return all urgent calls quickly. 407-496-3596

Dino